

Spohn Ranch Skateparks presents

The Skate Plaza

Featuring Skateable Art

combining the best of public sculpture and modern skate spots



Incorporating skaters into the community and recognizing skating as a healthy & legal activity, Skate Plazas tear down the fences between skaters and the public, creating positive spaces for personal development and physical fitness.

Spohn Ranch designs and builds accessible and visually pleasing skate plazas with sound-baffling materials which compliment their surrounding areas.

With skateable amenities usable by both skaters and pedestrians, Spohn Ranch skate plazas enhance the atmosphere of skating and mixed-use areas, widening the scope of activities offered to your community's youth.



Quick Installation & Small Footprint =

minimal disturbance of existing spaces & adjacent properties

Street Inspired Design

Aaron Spohn's Design Research

traveling the world to capture the best in design

85% of today's skaters are street skaters

Over 95% of skaters ages 10-16 prefer street obstacles to quarter-pipes.

Skate plazas keep skaters off the street, by bringing the street to them.



Aaron Spohn has designed and built skateparks across the globe. In his travels, he's visited and photographed over 2,500 skateparks and skate spots. One of the top designers in skateparks, Aaron always keeps ahead of the latest trend.

He combines this research with his experience as a pro skater and the input of other top pro skaters to effectively translate the hottest street skate spots into engineered, architecturally pleasing plazas.

This allows him to design spaces where skateable art and plaza features are organically integrated with the traffic flows of the park. The result is a park with strong skate lines and areas for spectators and non-skaters.



Real Plaza Architecture

bringing high end plaza design to skateparks



Skaters are drawn to complex obstacle groupings with multiple skating lines. The use of unskateable space like stairs and grass gaps creates challenge areas for skaters to conquer. As they master each gap, they experience personal growth & positive reinforcement.

Ironically, the most famous skate spots in the world were built by non-skatepark builders. By fine tuning the best plaza designs, Spohn Ranch can turn a skatepark into a positive community space.



Skate Plaza Planning

redefining the design process

a simpler method to reduce design times and design fees



By using advanced 3D modeling software and Google Earth integration, we shorten the trial and error period typical of skatepark design.

The average concrete skatepark projects uses 30% of its budget for design and engineering fees.

The average for a Spohn Ranch concrete skatepark is less than 5%.

By using pre-engineered skate elements, we eliminate the need for structural engineering.

By incorporating design fees into component pricing, we reduce the start-up costs of a project.

By providing every client with a Guaranteed Maximum Price, you won't pay for a design that can't be built for your desired budget.

The image above is a Google Earth image of a proposed site with a Spohn Ranch design incorporated in true scale.

This allows our clients to see exactly how the finished park will look before construction begins.

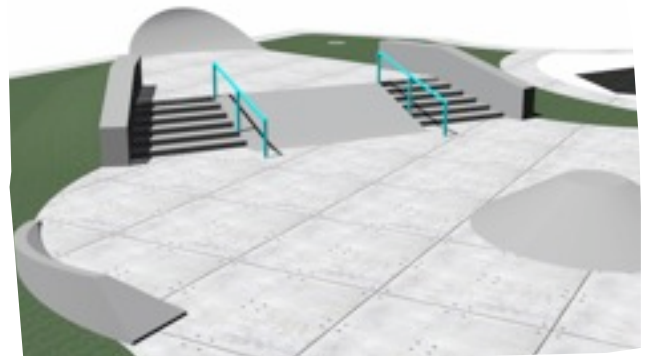

3D Close Up of Rendering
skaters can see the park in true scale

A new chapter in skate plazas

The LA Skate Plaza

converting a ramp park into a concrete skate plaza

giving new life to older skateparks



The City of LA wanted to replace an aging ramp park with a modern concrete skate plaza.

Spohn Ranch was able to customize the existing slab, creating a concrete park with seamless transitions and no approach plates.

The park was co-designed with X-Games & Maloof Money Cup winner Paul "P-Rod" Rodriguez, Jr.

The park's installation took less than 2 weeks with no site work or change orders.

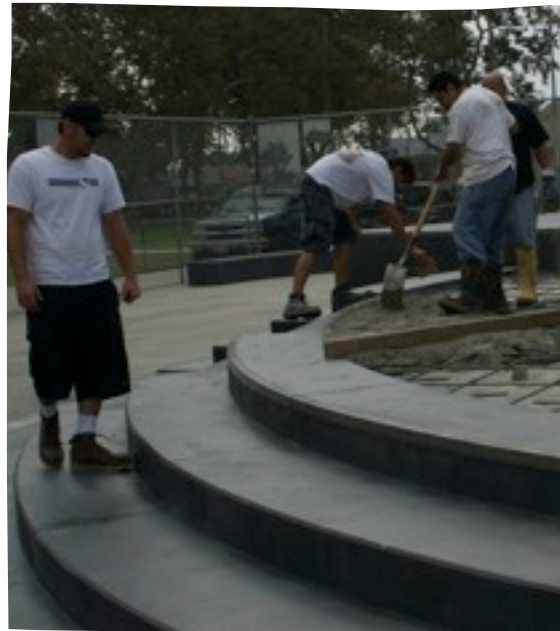

Using pre-cast plaza elements as retaining walls allowed for a low-cost central plaza with multiple skate lines and challenging obstacles.

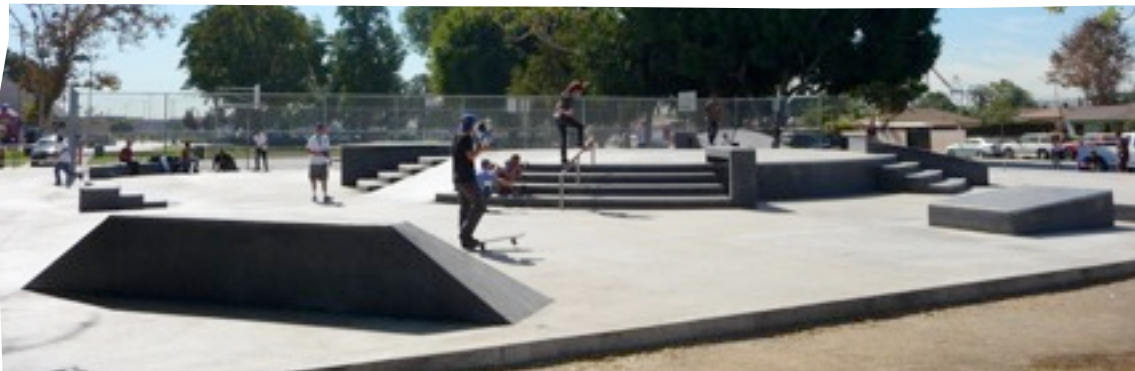

Pro Skate Sessions at the

LA Skate Plaza

the new destination for street skaters

Ever since the grand opening featuring Paul "P-Rod" Rodriguez, Daewon Song and Torey Pudwill, the LA Skate Plaza has hosted over a dozen magazine and video shoots with amazing pro skaters like Brian Sumner, Chad Tim Tim, Leo Romero, and Alex Gourdouros.



Above, Paul "P-Rod" Rodriguez, Jr. slides down the rail a the grand opening on September 27th, 2008.



At left, photographers and videographers from Transworld, Havoc TV and other skate publications shoot Alex Gourdouros' 180 kickflip down the stairs at the LA Skate Plaza.

Building parks for today's skater

LA Skate Plaza

serving the skating community more efficiently

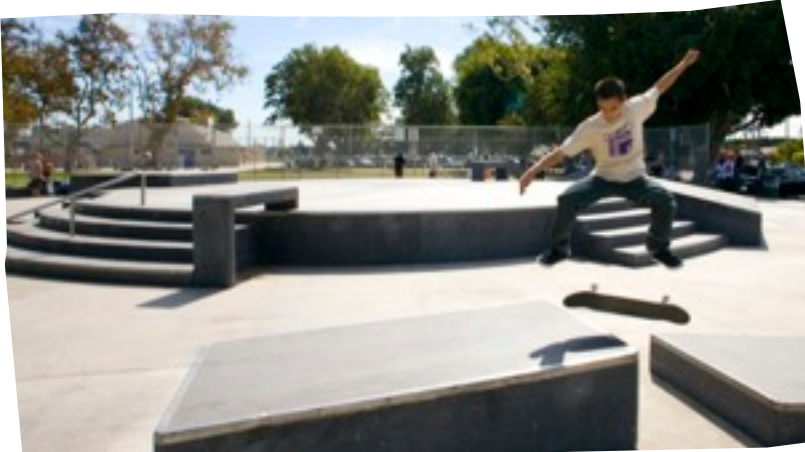

Besides providing a backdrop for pro videos, the LA Skate Plaza has become a home to hundreds of local skaters. Because the entire park is a street plaza, they're not crowded into 1/2 of the park while the bowl section is used less frequently.

Because 85% of skaters use the street-oriented section of a typical a 10,000 sq. ft. skate plaza serves as many skaters as a 17,500 sq. ft. typical street/bowl park.



Plaza Design Concepts

inspiration for your community's design process



While every Spohn Ranch Skate Plaza is a custom creation, we have an extensive library of conceptual designs that can help municipalities in their own design process.

By using one of our designs as a springboard, you know that you're starting with a solid foundation with safe traffic patterns and obstacle placement.

Plaza Design Concepts

inspiration for your community's design process

We have long-standing relationships with landscape architects and general contractors across the country.

This lets us serve as a single vendor for all your skatepark needs.

An increasing number of communities are also "sole sourcing" Spohn Ranch for skatepark purchases. This is due to both our unique experience and the unique products and services we offer.

